

Customer Information Sheet

DRAWING No.: M80-891XXXX

SHEET 2 OF 2

IF IN DOUBT - ASK

(C)

NOT TO SCALE

THIRD ANGLE PROJECTION

ALL DIMENSIONS IN mm

SPECIFICATION

MATERIAL:
 MOULDING = GLASS-FILLED POLYESTER, UL94V-0
 CLIP = BERYLLIUM COPPER
 SHELL = BRASS

FINISH:
CONTACTS:
 01 = 0.30 μ GOLD CLIP, 4.0 μ TIN/LEAD SHELL
 05 = 0.30 μ GOLD CLIP, 0.28 μ GOLD SHELL

ELECTRICAL:
 CURRENT RATING AT 25°C = 3.0A MAX
 CURRENT RATING AT 85°C = 2.2A MAX
 WORKING VOLTAGE = 120V AC/DC
 VOLTAGE PROOF = 360V AC/DC

CONTACT RESISTANCE:
 INITIAL = 20m Ω MAX
 AFTER CONDITIONING = 25m Ω MAX
INSULATION RESISTANCE:
 INITIAL = 1000M Ω MIN
 AFTER CONDITIONING = 100M Ω MIN

ENVIRONMENTAL:
 TEMPERATURE RANGE = -55°C TO +125°C

MECHANICAL:
 DURABILITY = 500 OPERATIONS
 INSERTION FORCE = 2.8N MAX, 1.0N MIN
 WITHDRAWAL FORCE = 1.8N MAX, 0.2N MIN

PACKING:
 TUBE
 FOR COMPLETE SPECIFICATION, SEE COMPONENT SPECIFICATION C005XX (LATEST ISSUE)

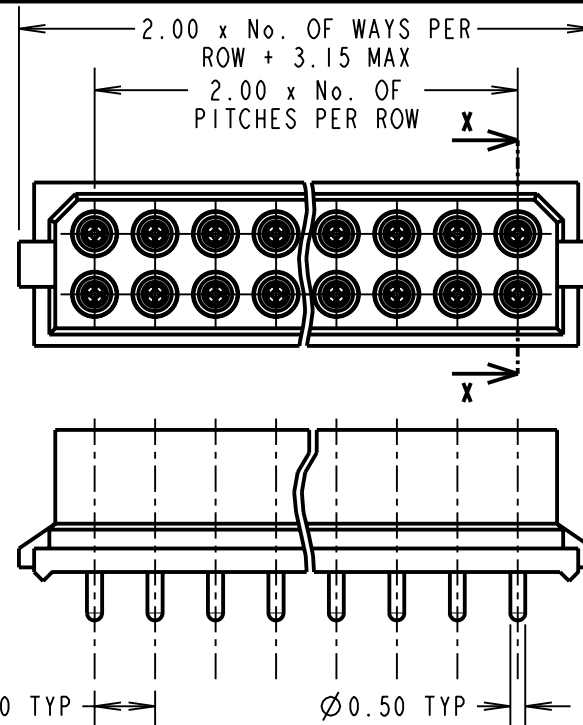
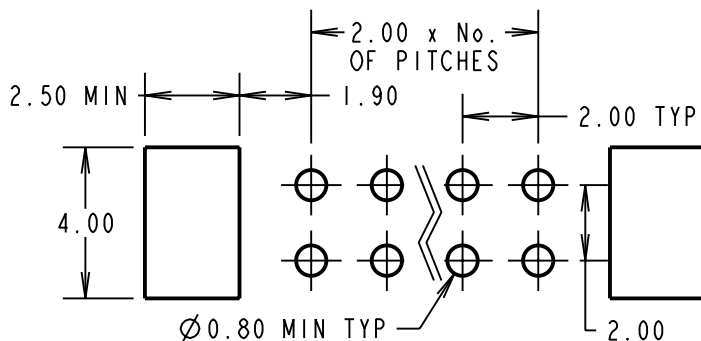
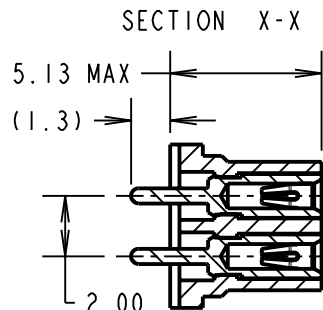

RECOMMENDED PCB LAYOUT

BRITISH STANDARD
 ORDER CODE: TO BS9525 F0033
B5741-2XX-F-N-X
 TOTAL No. OF WAYS
 04 - 20 (EVEN NUMBERS)
 26, 34, 44
 FINISH
 0 - GOLD CLIP, TIN/LEAD SHELL
 2 - GOLD CLIP, GOLD SHELL

COMMERCIAL
 ORDER CODE:
M80-891XXXX
 TOTAL No. OF WAYS
 04 - 20 (EVEN NUMBERS)
 26, 34, 44
 FINISH
 01 - GOLD CLIP, TIN/LEAD SHELL
 05 - GOLD CLIP, GOLD SHELL

SM	6	12.05.10	10790
NAME	ISS.	DATE	C/NOTE
APPROVED: S. MCCULLAGH			
CHECKED: R. ADDE			
DRAWN: W. J. BOURNE			
CUSTOMER REF.:			
ASSEMBLY DRG:			

HARWIN

HARWIN USA TEL: 603 893 5376 FAX: 603 893 5396 mis@harwin.com	HARWIN Europe (UK) TEL: 023 9231 4545 FAX: 023 9231 4590 mis@harwin.co.uk	HARWIN Asia TEL: +65 6 779 4909 FAX: +65 6 779 3868 mis@harwin.com.sg
--	--	--

THIS DRAWING AND ANY INFORMATION OR DESCRIPTIVE MATTER SET OUT HEREON ARE CONFIDENTIAL AND COPYRIGHT PROPERTY OF THE HARWIN GROUP AND MUST NOT BE DISCLOSED, LOANED, COPIED OR USED FOR MANUFACTURING, TENDERING OR FOR ANY OTHER PURPOSE WITHOUT THEIR WRITTEN PERMISSION.

TOLERANCES
 X. = ± 1 mm
 X.X = ± 0.25 mm
 X.XX = ± 0.10 mm
 X.XXX = ± 0.01 mm
ANGLES = $\pm 5^\circ$
 UNLESS STATED

MATERIAL:
 SEE ABOVE
FINISH:
 SEE ABOVE
S/AREA:
 mm²

TITLE: DATAMATE 2mm PITCH
 VERTICAL 1.3mm PC TAIL DIL
 SOCKET ASSEMBLY
DRAWING NUMBER:
M80-891XXXX
SHT
 2
OF
 2